

Quick Reference

WS300 Wastewater Sampler

Composite Sampler with Programmable Timer Control
Collects water samples from remote locations, aggregated over a time period programmable by the user.



Basic Setup & Operation:

- Open the Sampler and remove manual and the battery charger from the enclosure for safe storage while sampler is in field use.

• Secure the sample bottle:

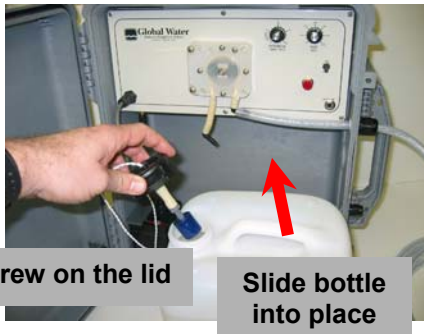

Screw on the lid

Slide bottle into place



Insert discharge hose into cap

Plug in float switch

• Secure the Sampler Upright:

Against strong winds, vandalism, accidental bumps, or high water. The unit may be suspended by the black handle and padlocked.

Do not submerge unit.



The Sampler MUST be kept upright to operate
(The sample bottle's float switch must be vertical.)



- **Avoid drilling holes** through enclosure, especially in control panel area. Seal any holes made in the enclosure with silicone sealant to prevent water intrusion into the unit.

- **Locate the Pickup Hose in a wastewater discharge channel or stream**, ensuring that the pickup strainer is fully submerged, but held off the bottom to avoid picking up debris.



Turn ON the sampling unit

Manual Pump Test



WS300 Wastewater Sampler (cont'd)

Calibrating the Sampler – Automatic composite sampling

The composite sample size is approximate, and varies with distance from the sampler. If precise sample sizes are needed, follow these steps for manual calibration:

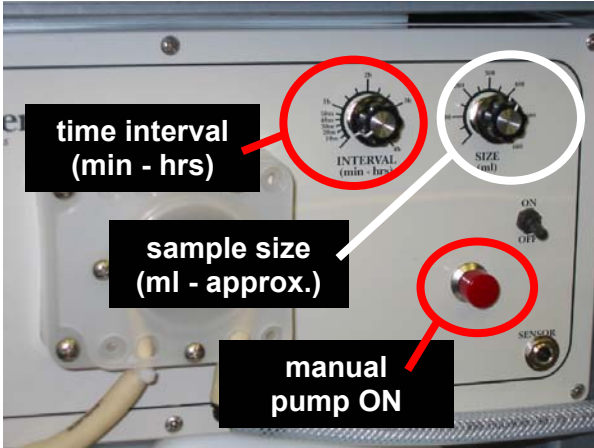

- Use a graduated cylinder larger than the needed sample size.
- Remove the sample bottle, but leave the float switch plugged into control panel.
- Adjust sample SIZE knob to roughly what's needed.
- Place cylinder in position to collect output of pump.
- Turn ON sampler with manual ON button.
- Check collected amount and adjust SIZE knob accordingly.
- Repeat above steps until final result is achieved.
- Remember to return pump output hose to sample bottle once reinstalled into position. Also, check that the float switch is plugged into the control panel (underneath).

Flow Proportional Sampling

The WS300 may take samples each time a specified amount of flow passes through a flow monitor (separate of unit).

- The flow monitor must provide a momentary switch closure (100 msec or longer) whenever a sample is to be taken.
- This output signal must be wired to a 1/4" phone plug (2 wire) then inserted into the SENSOR jack on the control panel.
- Set the INTERVAL knob to 4 hrs (max) and the sample SIZE value as desired.

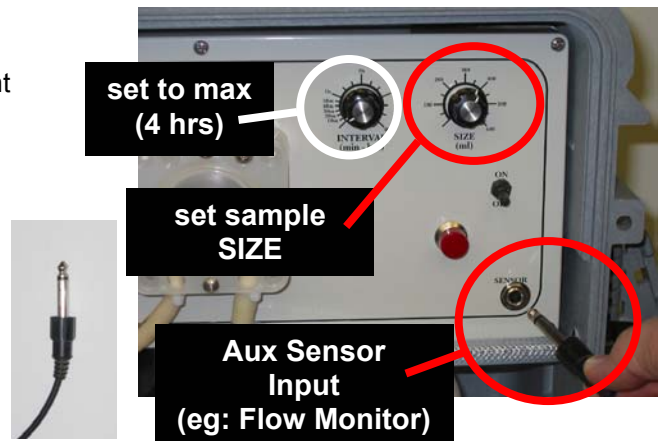

Other Maintenance

- **Check pump speed and battery voltage.**

Note the sound of a properly running pump. Run it manually (by pushing the "Sample Now" button) and listen to the sound - **if it grinds slowly, the battery may need charging.**

Verify the charge with a voltage meter to ensure the battery has not dropped to less than 10.5 volts. Recharge the battery by removing the leads connecting it to the sampler and connecting it to the supplied transformer (which plugs into a 110vAC wall socket). Connect Red to Red, Blue to Black. Full recharge takes about 12 hours.



NOTE: The battery life will last longer if recharged before it drains below 10.5 volts.



In the U.S. call toll free
at 1-800-876-1172
International: 916-638-3429
Fax: 916-638-3270
Email: globalw@globalw.com

Visit our online catalog at:
www.globalw.com
Our Address:
11390 Amalgam Way
Gold River, CA 95670